

Lighted Pylon

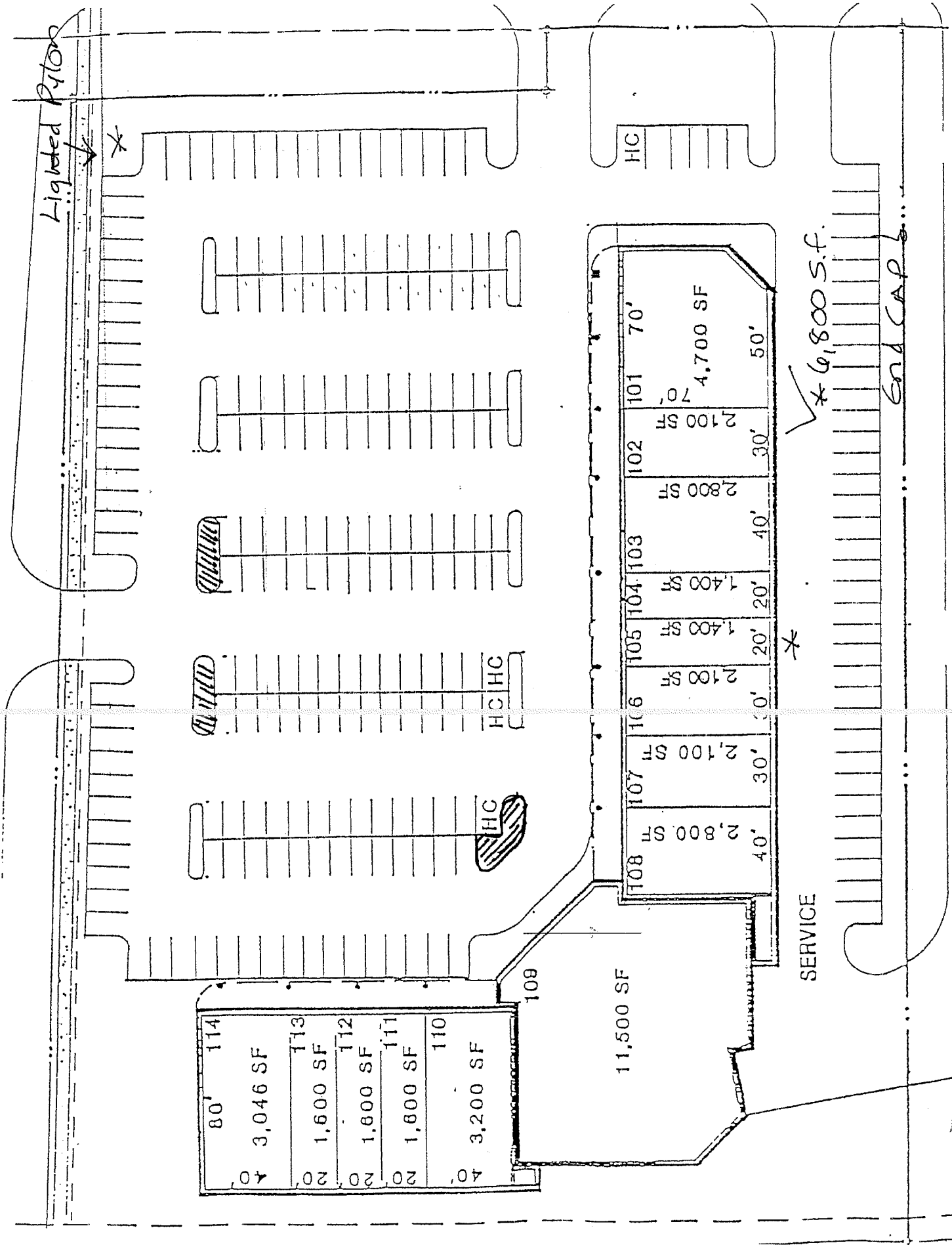

80'	114
3,046 SF	113
1,600 SF	112
1,600 SF	111
1,600 SF	110
3,200 SF	
40'	

108	107	106	105	104	103	102	101	70'
2,800 SF	2,100 SF	2,100 SF	2,100 SF	1,400 SF	1,400 SF	2,800 SF	2,100 SF	4,700 SF
40'	30'	30'	20'	20'	40'	30'	70'	50'

\* 6,800 S.F.

SERVICE

End Cap

HC

HC HC

HC

108

11,500 SF